

NETAJI STADIUM

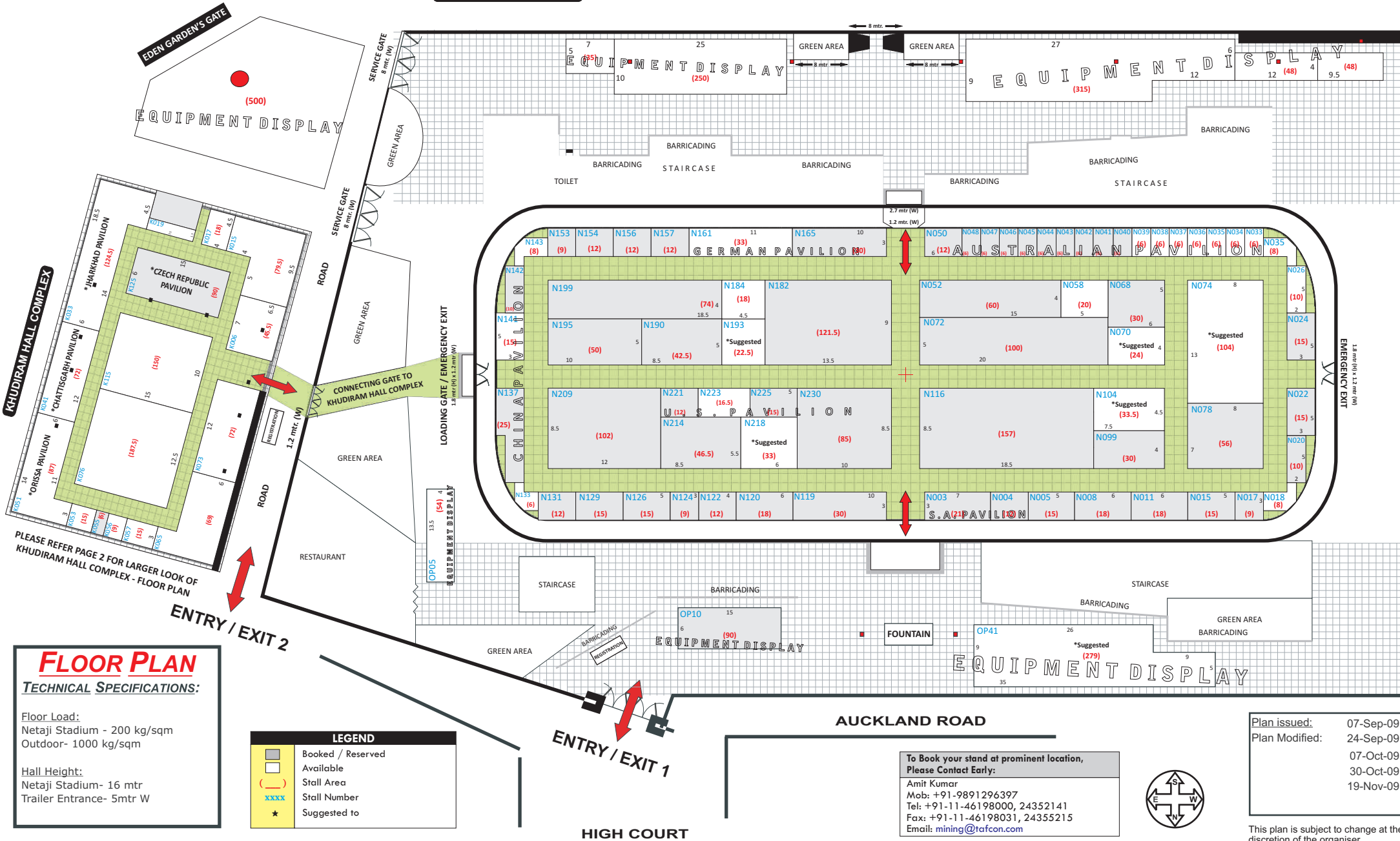

FLOOR PLAN
TECHNICAL SPECIFICATIONS:

Floor Load:
Netaji Stadium - 200 kg/sqm
Outdoor - 1000 kg/sqm

Hall Height:
Netaji Stadium - 16 mtr
Trailer Entrance - 5mtr W

LEGEND	
	Booked / Reserved
	Available
	Stall Area
xxxxx	Stall Number
*	Suggested to

To Book your stand at prominent location, Please Contact Early:

Amit Kumar
Mob: +91-9891296397
Tel: +91-11-46198000, 24352141
Fax: +91-11-46198031, 24355215
Email: mining@tafcon.com



Plan issued:	07-Sep-09
Plan Modified:	24-Sep-09
	07-Oct-09
	30-Oct-09
	19-Nov-09

This plan is subject to change at the discretion of the organiser



International Mining, Exploration Mineral Processing Technology & Machinery Exhibition

FRI 22nd - MON 25th JANUARY, 2010

Netaji Stadium & Khudiram Hall Complex, Kolkata, INDIA

Concurrent with **3rd Asian Mining Congress**

www.internationalminingexhibition.com

KHUDIRAM HALL COMPLEX

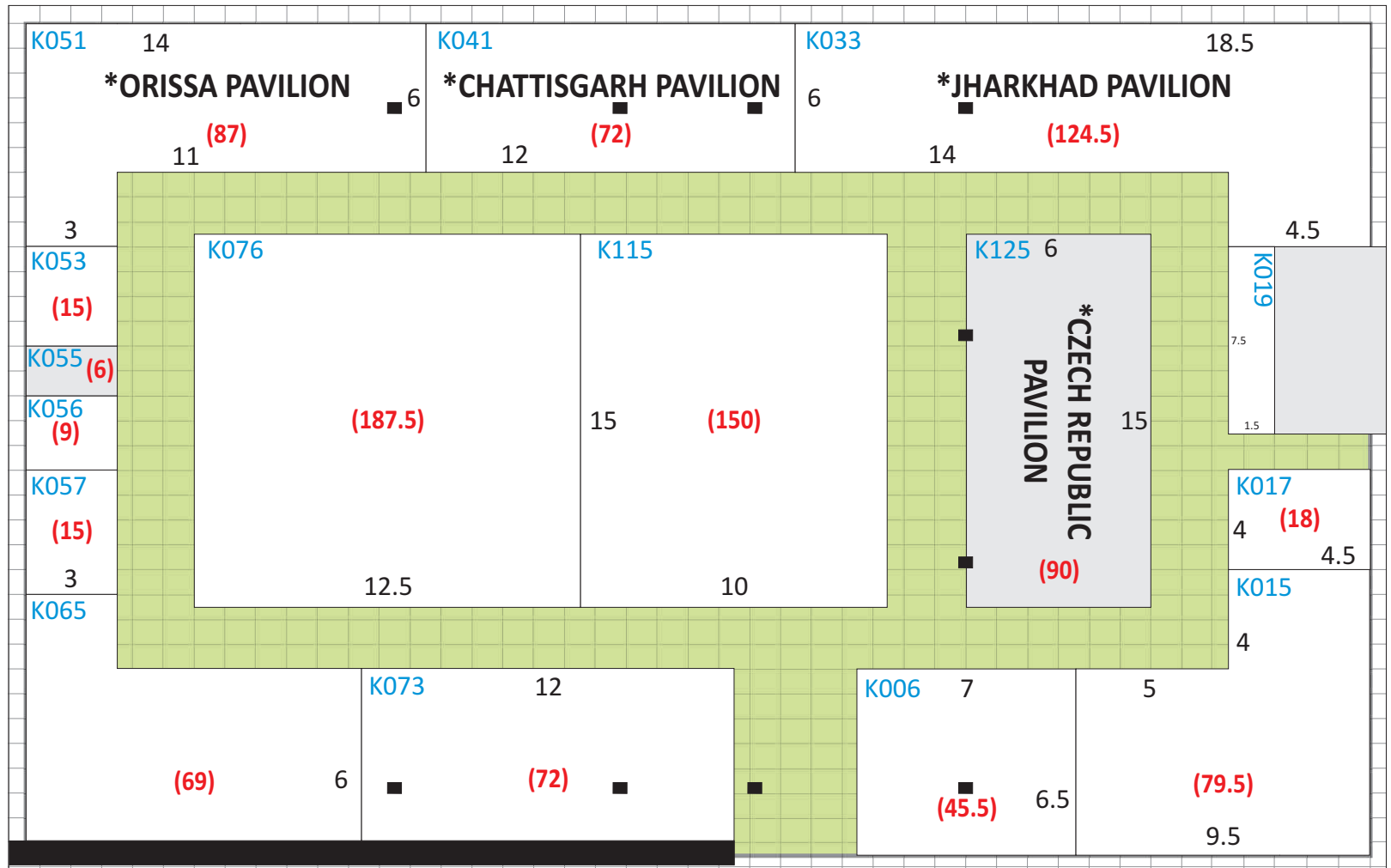

LEGEND	
	Booked / Reserved
	Available
()	Stall Area
xxxx	Stall Number
★	Suggested to

To Book your stand at prominent location, Please Contact Early:

Amit Kumar
 Mob: +91-9891296397
 Tel: +91-11-46198000, 24352141
 Fax: +91-11-46198031, 24355215
 Email: mining@tafcon.com